

SOLIDWORKS

2026

BLOG

A Note to Our Readers

2026

This blog has been created using a combination of artificial intelligence tools and human review to help deliver clear, structured, and up-to-date learning content.

All technical topics, examples, and workflows are curated to support learning and skill development. While every effort is made to ensure accuracy and clarity, readers are encouraged to validate concepts through hands-on practice and documentation. Our goal is to make learning more accessible, efficient, and practical for everyone.

Disclaimer:

All product names, logos, brands, and registered trademarks mentioned in this publication are the property of their respective owners and are used for identification purposes only.

— CADIN360 Team

UNDERSTANDING X Y Z DIRECTIONS SIMPLY IN SOLIDWORKS

• LEARN • • APPLY • • GROW •

Introduction

Understanding X, Y, Z directions simply in SolidWorks is fundamental for creating precise 3D models, assemblies, and technical drawings. These directions serve as the foundation for defining how parts transform, move, or align within the software. Mastering these axes helps improve modeling efficiency, ensure accuracy, and enhances your ability to work with complex geometry. Whether you're a beginner or an experienced user, grasping these directional concepts is essential to take full advantage of SolidWorks' powerful design tools.

What Are the X, Y, and Z Directions in SolidWorks?

In SolidWorks, the primary coordinate system is based on three mutually perpendicular axes: X, Y, and Z. These axes define directions and positions in 3D space, enabling you to create, manipulate, and position components accurately.

- **X-axis:** Typically runs horizontally from left to right.
- **Y-axis:** Usually runs vertically from front to back.
- **Z-axis:** Runs perpendicular to the X-Y plane, often representing height or depth.

Understanding these axes allows you to build models more intuitively, set up constraints, and specify directions for features like extrudes, cuts, or patterning.

How to Visualize X, Y, Z Directions in SolidWorks

SolidWorks provides a visual cue for axes through the origin point and the triad icon. Here's how to identify the directions:

1. View the Triad Arrow Indicator

- The triad icon, located in the graphics area, displays three arrows representing the axes.
- By default, it appears at the origin or can be repositioned in the space options.

2. Use the Coordinate System

- The origin point (0,0,0) is where all three axes intersect.
- You can add a coordinate system for specific orientations.

3. View Axes in Different Orientations

- Rotate the model to see how the axes align in 3D space.
- Use “View Orientation” or shortcut keys (e.g., Spacebar) to set standard views like Top, Front, or Right.

Working with X, Y, Z Directions in SolidWorks: Step-by-Step Guide

Understanding how to work with these axes is crucial for features like extrusions, cuts, patterns, and assemblies. Here's a practical approach:

1. Creating a New Sketch with Defined Directions

- Start a new sketch on a face or plane.
- Use the sketch tools to draw features aligned with the axes.
- Always pay attention to the orientation to ensure features are creating in the correct direction.

2. Using the Extrude Boss/Base Tool

- Select the feature you want to extrude.
- In the Direction 1 section, specify the distance along the Z-axis by default (or X/Y if your model orientation differs).
- Use the "Reverse Direction" option if needed to flip the extrusion.

3. Defining Movements and Constraints

- When working with mates or motions in assemblies, specify directions based on X, Y, or Z axes.
- Use "Mate Alignment" options to constrain parts along specific axes.

4. Pattern Features Along a Direction

- Choose the pattern type (linear, circular, or sketch driven).
- For linear patterns, select the direction (X, Y, Z).
- Set the spacing and number of instances.

Practical Examples of Using X, Y, Z Directions

Example 1: Extruding a Plate Along Z-Axis

- Draw a rectangle on the XY plane.
- Use the Extrude feature and specify the height along the Z direction.
- This creates a plate standing upright.

Example 2: Creating a Hole Pattern Along X and Y

- Create a sketch with grid points.
- Use "Pattern Driven" or "Linear Pattern" features.
- Select the X or Y axes as pattern directions for even spacing.

Example 3: Assembly Mates in Z Direction

- Mate two components with a "Coincident" mate along the Z axis.

- Ensures proper stacking or alignment vertically.

Common Mistakes in Understanding and Using X, Y, Z Directions

- **Assuming Default Orientation:** Not all models start with the same axis orientation; always verify your coordinate system.
- **Misaligned Sketch Planes:** Sketching on a plane not aligned with the desired direction can cause confusion.
- **Incorrect Extrude or Cut Direction:** Forgetting to check "reverse" options can lead to features extending in unintended directions.
- **Ignoring Global vs. Local Axes:** Relying only on global coordinates may limit control when working with assemblies or sub-assemblies.

Pro Tip: Keep your model orientation consistent, and when in doubt, use the triad to verify directions visually.

Best Practices for Managing Directions in SolidWorks

- Always name your coordinate systems if working on complex assemblies.
 - Use the "Display/Delete Relations" tool to create references along axes.
 - For intricate patterns or features, create reference geometry like axes or planes aligned with desired directions.
 - Use "Measure" tool periodically to verify directions and distances.
-

Comparing Global and Local Coordinate Systems in SolidWorks

Feature	Global Coordinate System	Local Coordinate System
Definition	Fixed to the entire model	Attaches to specific parts or features
Use	For general alignment	For feature-specific orientation
Flexibility	Limited, remains static	Dynamic, moves with the part

When to Use	Basic modeling and assembly	Complex features and mating
-------------	-----------------------------	-----------------------------

Understanding when to use global versus local coordinate systems allows for better control over model orientation and feature creation.

Conclusion

Mastering the understanding of X, Y, Z directions simply in SolidWorks is essential for efficient CAD modeling. These three axes serve as the backbone of 3D design, influencing how features are created, positioned, and constrained. Whether you're assembling parts, creating patterns, or designing intricate features, a clear understanding of the coordinate system helps you work more accurately and confidently. Keep practicing with real-world examples, watch out for common mistakes, and leverage the visual cues provided by SolidWorks for the best results.

FAQ

1. How do I change the axis orientation in SolidWorks?

Ans: You can change axis orientation by creating custom coordinate systems or using the "Coordinate System" feature and aligning it with your desired axes.

2. What is the default axis orientation in SolidWorks?

Ans: The default in SolidWorks is a Cartesian coordinate system with the X-axis running horizontally, Y-axis vertically, and Z-axis perpendicular to the XY plane.

3. How can I view the axes clearly in my model?

Ans: Use the triad icon or add coordinate systems for better visibility, and rotate your view to see axes from different angles.

4. How do I ensure my sketches are aligned with a specific axis?

Ans: When creating sketches, select the appropriate plane or face aligned with the desired axis and use construction lines or reference geometry for precise alignment.

5. Can I rename the axes in SolidWorks?

Ans: No, axes are part of the model's coordinate system and cannot be renamed, but you can add user-defined coordinate systems with custom labels for clarity.

6. How do I create a pattern along a specific axis?

Ans: Use the "Linear Pattern" feature, select the axis (X, Y, or Z) as the pattern direction, and define the spacing and count.

7. What are best practices for working with multiple coordinate systems?

Ans: Create and name custom coordinate systems for different assemblies or features, and switch between them as needed to maintain clarity.

About CADIN360

2026

CADIN360 Learning Tutorials is an educational platform focused on practical CAD, CAM, and CAE learning.

The platform provides clear, industry-oriented tutorials, design workflows, and real-world insights using tools such as SolidWorks.

CADIN360 is created to help learners, students, and professionals build strong fundamentals and practical design skills in modern CAD workflows.

2026

Practice What You've Learned

You've just completed this blog and learned important concepts in SolidWorks.

To help you practice and apply what you've learned, the next pages include a sample from our SolidWorks book .This sample contains practice exercises and real-world practice tasks designed to strengthen your skills.

What you'll find next:

- ✓ Practice exercises from the book
- ✓ A brief overview of the complete book
- ✓ Options to explore or request the full sample

Your hands-on SolidWorks practice starts next.

SOLIDWORKS ALL IN ONE WORKBOOK

500+ PRACTICE EXERCISES

- Sketching

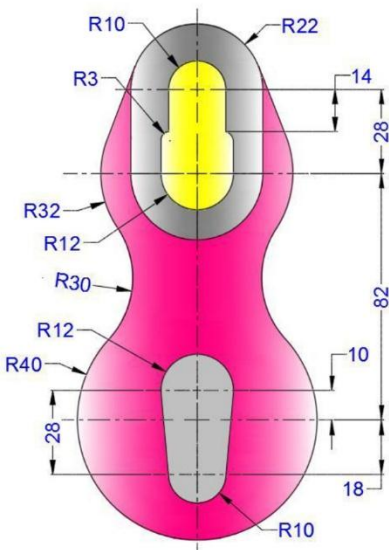

- 3D Modeling

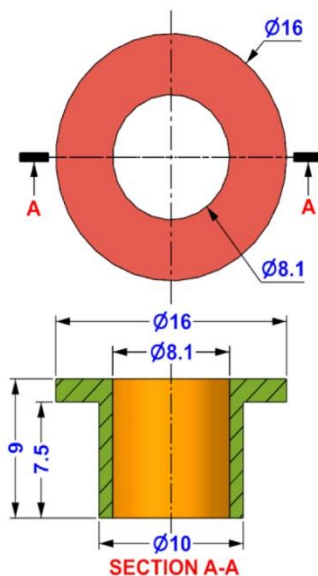

- Assembly

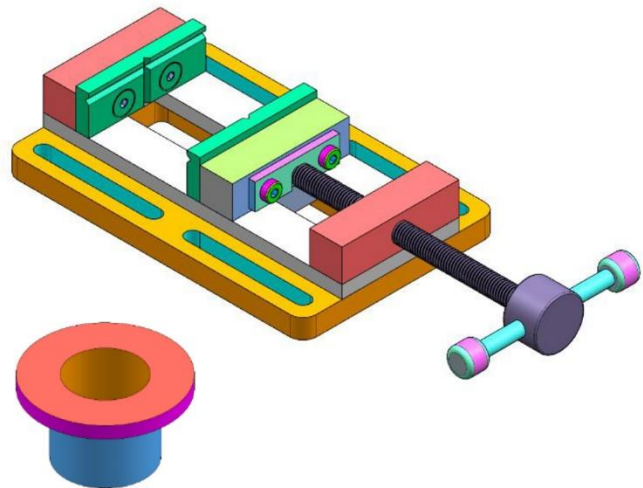

SACHIDANAND JHA

SOLIDWORKS ALL IN ONE WORKBOOK

500+ PRACTICE EXERCISES

• 2D Sketching • 3D Modeling • Assembly Drawings

SACHIDANAND JHA



Dear Reader,

Thank you for choosing the **SOLIDWORKS ALL IN ONE WORKBOOK**. This book is part of the CADIN360° learning series, created to help engineers, students, and professionals master SolidWorks through structured and practical exercises.

This book contains over 500 carefully crafted practice drawings, including:

- 200 2D Sketching Exercises
- 200 3D Modeling Exercises
- Comprehensive Assembly Models with 150+ Individual Part Drawings

We founded CADIN360 in 2016 with the goal of delivering practical, high-quality learning material for CAD software. More than 9 years later, we're still committed to producing consistently exceptional books. With each of our titles, we're working hard to set a new standard for the industry. From the paper we print on, to the authors we work with, our goal is to bring you the best books available.

I hope you see all that reflected in these pages. I'd be very interested to hear your comments and get your feedback on how we're doing. Feel free to let me know what you think about this or any other CADIN360 book by sending me an email at cadin360@gmail.com

If you think you've found a technical error in this book, please visit <https://cadin360.com/contact-us/>.

Customer feedback is critical to our efforts at CADIN360.

Best regards,

Sachidanand Jha
Founder & CEO, CADIN360



SOLIDWORKS ALL IN ONE WORKBOOK

Published by CADIN360

Website: cadin360.com

Copyright © 2025 by CADIN360, All rights reserved.

This book is copyrighted and the CADIN360 reserves all rights.

No part of this publication may be reproduced, stored in a retrieval system or transmitted, transcribed, stored in retrieval system or translated into any language, in any form or by any means, electronic, mechanical, photocopying, recording, scanning or otherwise, without the prior written permission of the publisher & Author.

Limit of Liability/Disclaimer of Warranty:

The publisher and the author make no representations or warranties with respect to the accuracy or completeness of the contents of this work and specifically disclaim all warranties, including without limitation warranties of fitness for a particular purpose. No warranty may be created or extended by sales or promotional materials. The advice and strategies contained herein may not be suitable for every situation. This work is sold with the understanding that the publisher is not engaged in rendering legal, accounting, or other professional services. If professional assistance is required, the services of a competent professional person should be sought. Neither the publisher nor the author shall be liable for damages arising herefrom. The fact that an organization or Web site is referred to in this work as a citation and/or a potential source of further information does not mean that the author or the publisher endorses the information the organization or Web site may provide or recommendations it may make. Further, readers should be aware that Internet Web sites listed in this work may have changed or disappeared between when this work was written and when it is read.

Examination Copies

Books received as examination copies in any form such as paperback and eBook are for review only and may not be made available for the use of the student. These files may not be transferred to any other party. Resale of examination copies is prohibited

Electronic Files & Usage Rights:

The electronic file/eBook in any form of this book is licensed to the original user only and may not be shared, distributed, resale or transferred to any other party. To access files, the user must contact **cadin360@gmail.com** with valid proof of purchase. Unauthorized distribution of the files is a violation of copyright law.

Disclaimer:

All product names, logos, brands, and registered trademarks mentioned in this publication are the property of their respective owners and are used for identification purposes only.

SOLIDWORKS ALL IN ONE WORKBOOK

- ❖ This book contains over 500 CAD practice exercises, organized as:
 1. 200 2D Sketching Exercises
 2. 200 3D Modeling Exercises
 3. Assembly Projects with 150+ Part Drawings
- ❖ This book is a practice workbook. It does not include step-by-step tutorials for creating 2D drawing, 3D models and Assembly.
- ❖ SI units (millimeters) are used for all dimensions.
- ❖ Third Angle Projection is used throughout this book.
- ❖ This book is for **SOLDIWORKS** and also suitable for Other Feature-Based Modeling Software such as Inventor, Catia, Fusion 360, NX, Solid Edge, AutoCAD, PTC Creo etc.
- ❖ Designed for students, engineers, drafters, and designers looking for extensive CAD practice using SolidWorks.
- ❖ The exercises cover a wide range of real-world modeling challenges—from simple sketches to complex assemblies—offering clear, concise, and structured drawing practice.
- ❖ Exercises are organized to gradually develop beginner to advanced-level design skills.
- ❖ Each exercise is self-contained, and can be completed independently.
- ❖ Assembly drawings follow industry standards to help improve visualization and multi-part modeling skills.
- ❖ All dimensions are in mm. Assume missing dimensions logically.

HOW TO USE THIS BOOK

This book contains over 500 CAD practice exercises, designed for self-paced learning using SOLIDWORKS or any feature-based modeling software.

- 2D Sketching Exercises: Start here if you're a beginner or learning how to use the sketch environment.
- 3D Modeling Exercises: Follow after mastering sketching. Practice creating solid models using the provided dimensions.
- Assembly Drawings: Use after completing part models to understand multi-part assemblies, relationships, and constraints.

Tips for Best Use:

- Complete the exercises in order, or jump to any skill level you prefer.
- All dimensions are in millimeters.
- Where dimensions are missing, apply logic or practice estimation.
- This book is ideal for both students and professionals preparing for industry design work.

Note:

This book is available in multiple formats – **Black & White**, **Standard Color**, and **Premium Color** editions.

Happy learning!
– Team CADIN360

3D

Get The Complete Practice Sample

You downloaded a single Exercise PDF

The complete practice sample for this software includes multiple exercises and is not available inside this PDF..

What you will receive

- A software-specific complete sample PDF
- Multiple real practice exercises (not a single file)
- Same quality as our professional training material
- Compatible with the latest software version

How to get the complete sample

Click the button below and **enter a valid email address**.
The **complete sample PDF will be delivered automatically**
after the form is submitted.

SEND THE COMPLETE SAMPLE TO MY EMAIL

END OF SAMPLE

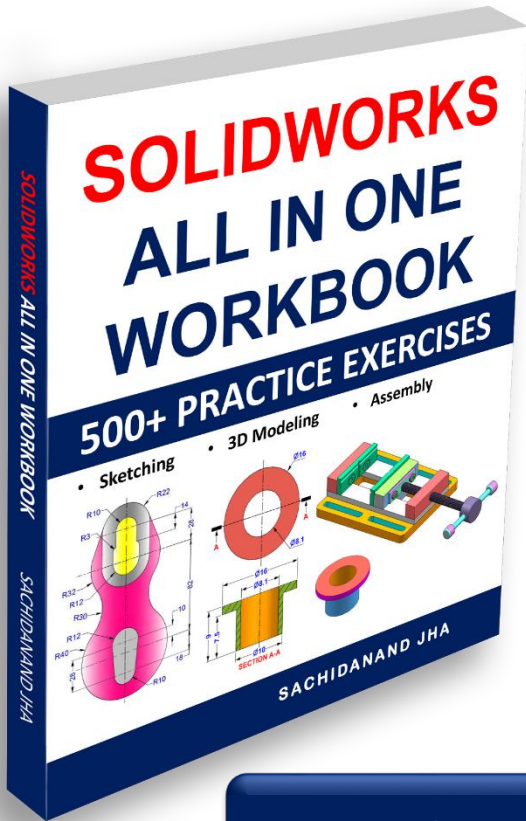

What's Included in the **SOLIDWORKS ALL IN ONE WORKBOOK?**

- ✓ Books contains exercises of Sketching, 3D Modeling & Assembly.
- ✓ 500+ Practice Exercises with Dimensions
- ✓ Full Assembly STEP Files (.stp format) – Compatible with all major CAD software
- ✓ Instant Download Link - Sent to Your Email After Payment
- ✓ Lifetime Access to All Files

Get the Paperback book on Amazon

Get the Complete Bundle for Only \$27.99

Special Offer for Students & Learners

Are you a Student, Unemployed or Financially struggling ?
Get this special Bundle only for \$19.99

Special Offer for Only \$19.99



Thank You for Learning with Us!

Thank you for choosing the **SOLIDWORKS ALL IN ONE WORKBOOK**. We hope this book helped you strengthen your CAD skills through hands-on practice and real-world design challenges.

Your feedback means the world to us!

If you found this book helpful, please take a moment to leave a **review** on the Amazon where you purchased it. Your kind words not only motivate us but also help other learners discover our resources. Scan the QR.

★ A good review goes a long way!

📖 Explore More CAD Practice Books

Looking to continue your learning journey? We offer similar practice-based books for over **30 CAD software platforms**, including:

- AutoCAD
- Fusion 360
- FreeCAD
- TinkerCAD
- TurboCAD
- Siemens NX
- CATIA
- Creo
- SketchUp and many more...

Visit our website 🖱️ www.cadin360.com to browse the complete collection.

💬 Stay Connected

Have suggestions, feedback, or just want to say hello?

We'd love to hear from you!

✉️ Email: cadin360@gmail.com

🌐 Website: www.cadin360.com

🚀 Keep Practicing. Keep Designing.

Whether you're a beginner or a pro, **practice is the key** to mastering any CAD software.

We're honored to be a part of your journey.

Happy Designing!

– Team **Cadin360**



Master **SolidWorks** with Real-World Practice Exercises

This book contains over 500 SolidWorks practice exercises including sketching, 3D modeling, and assembly drawings.

Designed for students, engineers, and professionals to build practical CAD modeling skills.

SOLIDWORKS ALL IN ONE WORKBOOK

This book contains:-

- 200 2D Sketching Exercises
- 200 3D Modeling Exercises
- Multi-part Assembly Exercises & Detailed Drawings
- All drawings in 3rd Angle projection
- All dimensions are in mm(metric system)